



Safe-Hit's 2 1/4" (57.2mm) diameter posts are constructed of durable linear low density, co-extruded polyethylene with UV inhibitors. They are designed with an innertube to help withstand vehicular impacts and are available in heights ranging from 18 inches (457.2mm) to 54 inches (1.3716m). Safe-Hit posts come standard with high intensity reflective sheeting. Decals can be used instead of reflective sheeting if desired. See page 11 for details.

SURFACE MOUNT SYSTEMS

Safe-Hit surface mount channelizers and tubular markers are easy to install and come standard with a convenient Surface Mount Pin Lock Base that allows post replacement in 30 seconds. The surface mount posts can be installed on asphalt or concrete using epoxy kits, butyl pads or mechanical anchors. Bases installed using a butyl pad or mechanical anchors can be re-used.

Specify post color and reflective sheeting colors when ordering.

- Standard Post Colors: White, Yellow or Orange
- Custom Colors: Light Gray, Dark Gray, Green, Blue, Black, Brown or Red
- Reflective Sheeting: Standard is high-intensity Silver, Amber or Orange (see page 12 for other reflective options)
- Custom Base Colors: Yellow or Orange

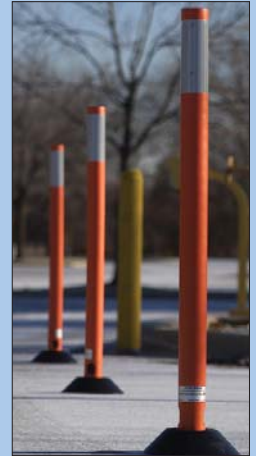

TYPE 1 HAZARD MARKER

Round post, flattened on top with black oval cap, three 3"(76.2m) x 3"(76.2m) reflective patches and Surface Mount Pin Lock Base.

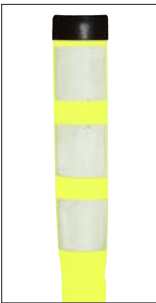

Size		Part No.
48"	1219mm	SH148SMA-YS

TYPE 3 CHANNELIZER

Round post with recessed cap, one 6" (152.4mm) reflective wrap and Surface Mount Pin Lock Base.



Size		Part No.
48"	1219mm	SH348SMA--WS
42"	1066mm	SH342SMA--WS
36"	914.4mm	SH336SMA--WS
28"	711.2mm	SH328SMA--WS
24"	609.6mm	SH324SMA--WS
18"	457.2mm	SH318SMA--WS

TYPE 2 GUIDE POST

Round post, flattened on top with black oval cap, one 3" (76.2mm) x 9" (228.6mm) reflective strip and Surface Mount Pin Lock Base.



Size		Part No.
48"	1219mm	SH248SMA--WS
42"	1066mm	SH242SMA--WS
36"	914.4mm	SH236SMA--WS
28"	711.2mm	SH228SMA--WS
24"	609.6mm	SH224SMA--WS
18"	457.2mm	SH218SMA--WS

TYPE 5 MARKER POST



Round post with recessed cap, two 3" (76.2mm) reflective wraps and Surface Mount Pin Lock Base.



Size		Part No.
48"	1219mm	SH548SMA--OS
42"	1066mm	SH542SMA--OS
36"	914.4mm	SH536SMA--OS
28"	711.2mm	SH528SMA--OS
24"	609.6mm	SH524SMA--OS
18"	457.2mm	SH518SMA--OS

BASE OPTIONS

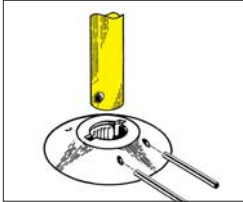
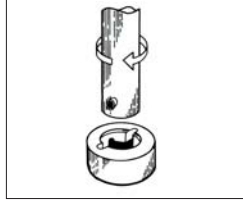
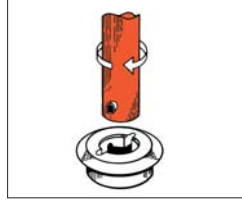
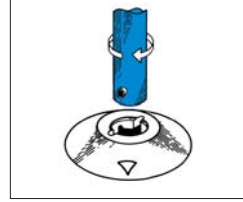
Safe-Hit's flexible surface mount posts come standard with a Surface Mount Pin Lock Base. You may substitute other bases.

SMA SURFACE MOUNT PIN LOCK BASE	SLT SUB-LEVEL TWIST LOCK BASE	SST SUB-SURFACE TWIST LOCK BASE	SMT SURFACE MOUNT TWIST LOCK BASE	PSB PORTABLE BASE
<p>Ideal for permanent installations.</p>	<p>Used when it is desirable to have the base level with the concrete or asphalt surface.</p>	<p>Used when a low profile is desired due to vehicular or pedestrian traffic.</p>	<p>Used when posts must be installed, removed and re-installed periodically.</p>	<p>No anchor or adhesive required. Ideal for temporary applications. Base is 18 lbs. (8.165kg)</p>
				
<p>Part No.</p> <p>SHSMA-1---BL</p>	<p>Part No.</p> <p>SHSLT-1---BL</p>	<p>Part No.</p> <p>SHSST-1---BL</p>	<p>Part No.</p> <p>SHSMT-1---BL</p>	<p>Part No.</p> <p>SHPSB-1---BL</p>

SAFE-HIT BASES WITH REFLECTIVE



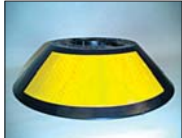

Safe-Hit base reflectors provide an extra level of visual warning. They are especially effective in high impact areas and twist lock applications that are frequently removed. Available in High Intensity or Diamond Grade, Amber and Silver reflective.

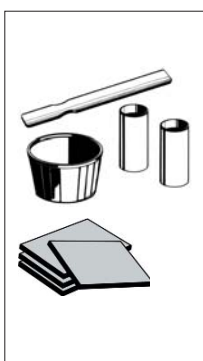

Part No.	Description
SHSMAxx1- -BL	Pin Lock base, Front Only
SHSMAxx2- -BL	Pin Lock base, Front & Back
SHSMAxx4- -BL	Pin Lock base, All Around
SHSMTxx1- -BL	Twist Lock base, Front only
SHSMTxx2- -BL	Twist Lock base, Front & Back
SHSMTxx4- -BL	Twist Lock base, All Around

ADHESIVES, HARDWARE & ACCESSORIES

	Epoxy Kit	For installing one base.	Part No. SHEPX-13--KI		Accessory Part	Part No.
	Case Epoxy Kit	For installing 25 bases.	SHEPX-25-CA		Oval Cap Black for Type 1 and Type 2 Posts	2023060-0006
	Butyl Pad	For installing one base.	SHBTL-23--KI		Oval Cap White for Type 1 and Type 2 Posts	2023060-0000
	Case Butyl Pads	For installing 40 Units.	SHBTL-24-CA		Round Cap	2023060-0000
	Lag Screws and Lag Anchors	Lag Screws can be used as a semi-permanent method of mounting the Safe-Hit surface mount bases.	SHSMALAG--01		Twist Lock Base Plug	SHBP--04TBL
	Hex Bolts and Drop-In Anchors	Bolts and Anchors can be used as a semi-permanent method of mounting the Safe-Hit surface mount bases.	SHSMADRI--01			
	Punch Pin Tool	For easy pin lock removal.	SHTOL----DRP			